

S200

Electromechanical
Swing Door Operator
Max. capacity 250 Kg



DESCRIPTION FOR TECHNICAL SPECIFICATIONS

Electromechanical Swing Door Operator TOPP, model S200, for pedestrian swing doors. It may be used for door widths up to 700mm and 1200 and a maximum weight of 250kg and 130kg respectively. Power supply 230V~ 50 Hz. With a minimalist and sober design, covered by an elegant steel-painted cover, the S200 is the ideal solution for prestigious environments, both residential and commercial: shops, offices, hotels and other contests that require an automatic swing door to successfully creating spaces.

Simple and easy to install due to the fitting plate, the reduced weight, the adjustable settings on the electronic board and the side switches for both the power supply and the function and reset selection.

In compliance with the EN16005 Standard, the S200 functions in either Full Power and Low Energy modes, where the latter does not require safety sensors due to the electronic control of force and weight. Due to the combination of 3 different types of arm - slide track arm, push arm and elbow slide track arm - with extension systems, this mechanism is very easy to configure and adapt to any wall and door type. In case of a power failure, a long-life battery pack will assure the operator's functioning.



Fitting plate for an easy installation to the wall.



Full Power or Low Energy modes can be easily selected from the electronic board.



On board batteries without automation changes on dimension.

TECHNICAL CHARACTERISTICS

Power supply:	230V ~ 50/60 Hz
Operation modes:	Full Power or Low Energy
Working system:	Electronic opening by motor – Mechanical closing by spring
Power supply for external accessories:	24V - 500mA max
Absorption:	0,65 A
Power absorbed:	150W
Type of use:	continuous
Max. opening speed:	50°/second
Adjustment of automatic closing time:	from 0 to 60s
Max. door-leaf weight:	250kg for leaf of up to 700mm – 130kg for leaf of up to 1200mm
Clear passage width:	
with push arm	min 600mm – max 1600mm
with slide track arm	min 650mm – max 1600mm
with elbow slide track arm	min 700mm (overlap max 100); min 850mm (overlap > 100mm)max1600mm.
Max. opening angle of push arm:	115°
Max. opening angle of slide track arm:	95°



DIMENSIONS

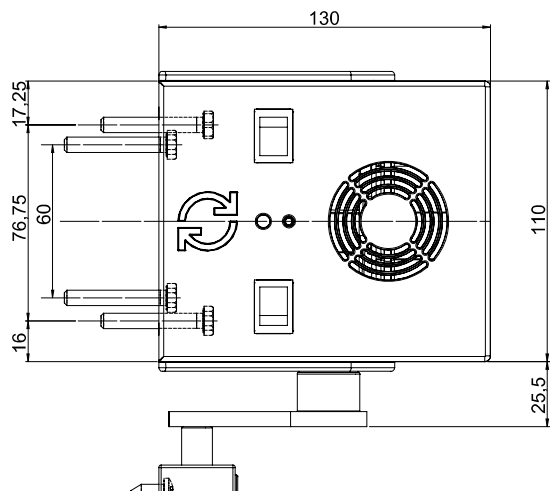

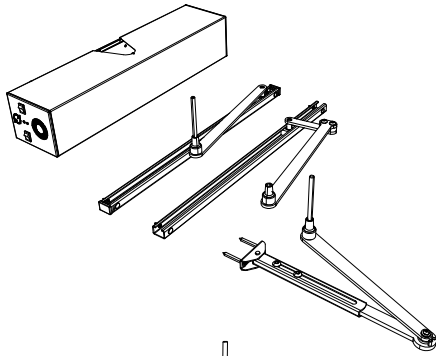

S200 ELECTROMECHANICAL SWING DOOR OPERATOR

(Max. capacity: 250kg for leaf of up to 700mm – 130kg for leaf of up to 1200mm)

CODE PRODUCT DESCRIPTION

3S1001 S200 - Electromechanical Swing Door Operator with spring and onboard battery (250kg for leaf of up to 700mm – 130kg for leaf of up to 1200mm)

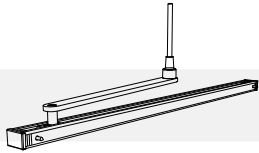

3S1020 SA1 Slide track arm (for lintel depths from 0 up to max. 30 mm)

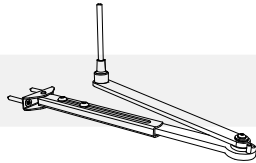

3S1010 AA1 Push arm (for lintel depths from 0 up to max. 100mm)

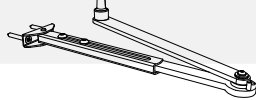

3S1011 AA2 Push arm (for lintel depths from 101 up to max. 200mm)



3S1012 AA3 Push arm (for lintel depths from 201 up to max. 300mm)

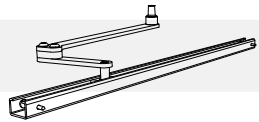

3S1030 EA1 Elbow slide track arm (for lintel depths from 0 up to max. 100mm)

3S1031 EA2 Elbow slide track arm (for lintel depths from 101 up to max. 220mm)

3S1100 PS1 Extension arm 25mm

3S1101 PS2 Extension arm 50mm

3S1102 PS3 Extension arm 75mm

Note: Electronic board with onboard receiver and possibility to control through TS1S radio remote control selector (as an alternative to MS1S and KS1S selectors).



S200 ACCESSORIES

CODE PRODUCT DESCRIPTION



8E1725 WS6 Microwave unidirectional activation radar



8E1712 IS6 Safety sensor for swing doors (length 900mm - safety range from 340mm up to 900mm) - black. Certified according to EN16005



8E1771 BF1 2 pieces Bea Flatscan safety sensors - white



8E1772 BF1 2 pieces Bea Flatscan safety sensors - black



8E1042 MS1S Manual control functions selector for swing door automation



8E1043 KS1S Control functions key selector for swing door automation



8E1055 TS1S 4-functions remote control selector for swing door automation (open, close, exit only mode, automatic mode)



8E1832 DS2S digital program switch with display for swing door automation - white



8E1833 DS2S digital program switch with display for swing door automation - black



8E1150 HS1 External gesture activation key



8E1091 PU1 Ultra-flat activation push pad



8E1142 TP1 Anti-entrapment system for automatic swing door hinges